

**K0451
Lil Barbie Trail Rider (TRU)
Toddler SERIES**

Age Range:	12-36 months
Weight Limit:	40 lbs. Grass/Asphalt/Hard Surfaces
Surfaces:	Grass/Asphalt/Hard Surfaces
Speed:	2 MPH Forward Pink Body/Purple Seat/Purple Wheels
Colors:	Pink/Purple Wheels
Intro:	2006
Suggested Retail:	\$79.99
Box Dimensions:	26.250 x 13 x 6.375;
Warranty:	17 lbs One Year Vehicle Six Months Battery

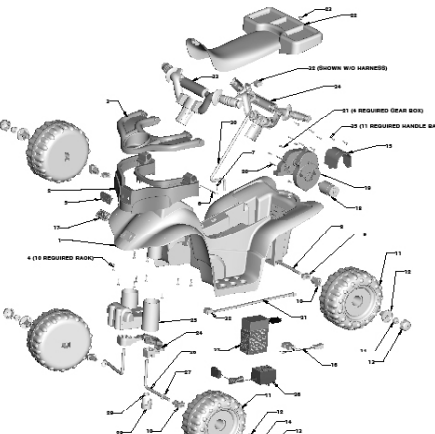

Part Number	Description	Quantity	Item
1 N/A	CHASSIS DRILLED	1	22 3800-8128
2 NA	RACK	1	23 78570-2439
3 K0451-2129	LID, STORAGE RACK	1	24 K0451-9329
4 0912-8001	#8 X .750 PH PLAS SCREW	10	25 K0451-2139
5 00801-1503	PW-EMBLEM	1	26 77760-4519
6 74230-4129	BATTERY RETAINER	1	27 0801-0253
7 0801-0228	#8-18 X 7/8 AB PHIL TRUSS	1	28 J8473-2359
8 77760-4529	REAR AXLE	1	29 0905-0116
9 74504-2549	BUSHING, RECT NO EXT	2	30 J8473-4539
10 78560-2659	BUSHING, RECT W/EXT	4	31 3800-7785
11 K0451-2919	WHEEL	4	32 00801-0697
12 N/A	BUSHING, RETAINER KEEPER	4	33 K0451-9209
13 K0451-2349	COVER, RETAINER KEEPER	4	34 K0451-9209
14 0801-0604	.354 RETAINER PALNUT	4	35 0912-6002
15 K0451-2159	MOTOR COVER	1	36 00801-0976
16 77760-9699	MAIN HARNESS	1	37 00801-1230
17 00801-1503	LOGO, PW-EMBLEM	1	
18 00968-3700	MOTOR, PINION	1	
19 00968-3800	#10 GB BLK	1	
20 00801-0198	M3-.5 X 32 MM NYLOK SCREW	2	
21 0801-0202	#8 x .500 PH PLAS SCREW	4	

Part Number	Description
SEAT LABELED	
LOCK FASTENER	
STEERING LINKAGE ASSY	
BRUSH GUARD	
FRONT AXLE	
5/16 TIGHT TOL WASHER	
STEERING ROD CAP	
3/18-16 NYLOK HEX NUT	
STEERING COLUMN	
HANDLEBAR HARNESS	
SWITCH, SIGNAL	
*HANDLEBAR, FRONT	
*HANDLEBAR, REAR	
#6 X .750 PLASTITE	
CHARGER 4AH	
6V, 4AMP BLUE BATTERY	

PARTS NOT SHOWN

Part Number	Description
00801-1567	Wrench
0801-0198	Lock Out Screw
00968-3900	Motor Gearbox Assy
K0451-0920	MANUAL

K0451-0310

DECAL SHEET

12/8/2006 8:38

Bold and Underlined parts are to be purchased and installed by Service Centers only. These may not be sold directly to consumer Service Centers or Fisher-Price. #33 & #34 are shown on the diagram. Both consist of the handlebar assy.