

Age Range: 3-7 Yrs.  
 Weight Limit: 65 Lbs.  
 Surfaces: Hard, Grass & Hills  
 Speed: 2.5 / 5.0 MPH  
 Colors: Yellow Body  
 Black Wheels  
 Red & Blue Trim

Intro: 1993  
 Warranty: 90 Vehicle  
 6 Months Battery

# 78680-9993/86560 CYCLE SOUND SUZUKI® QUAD RACER®

Youth Series  
 12-VOLT

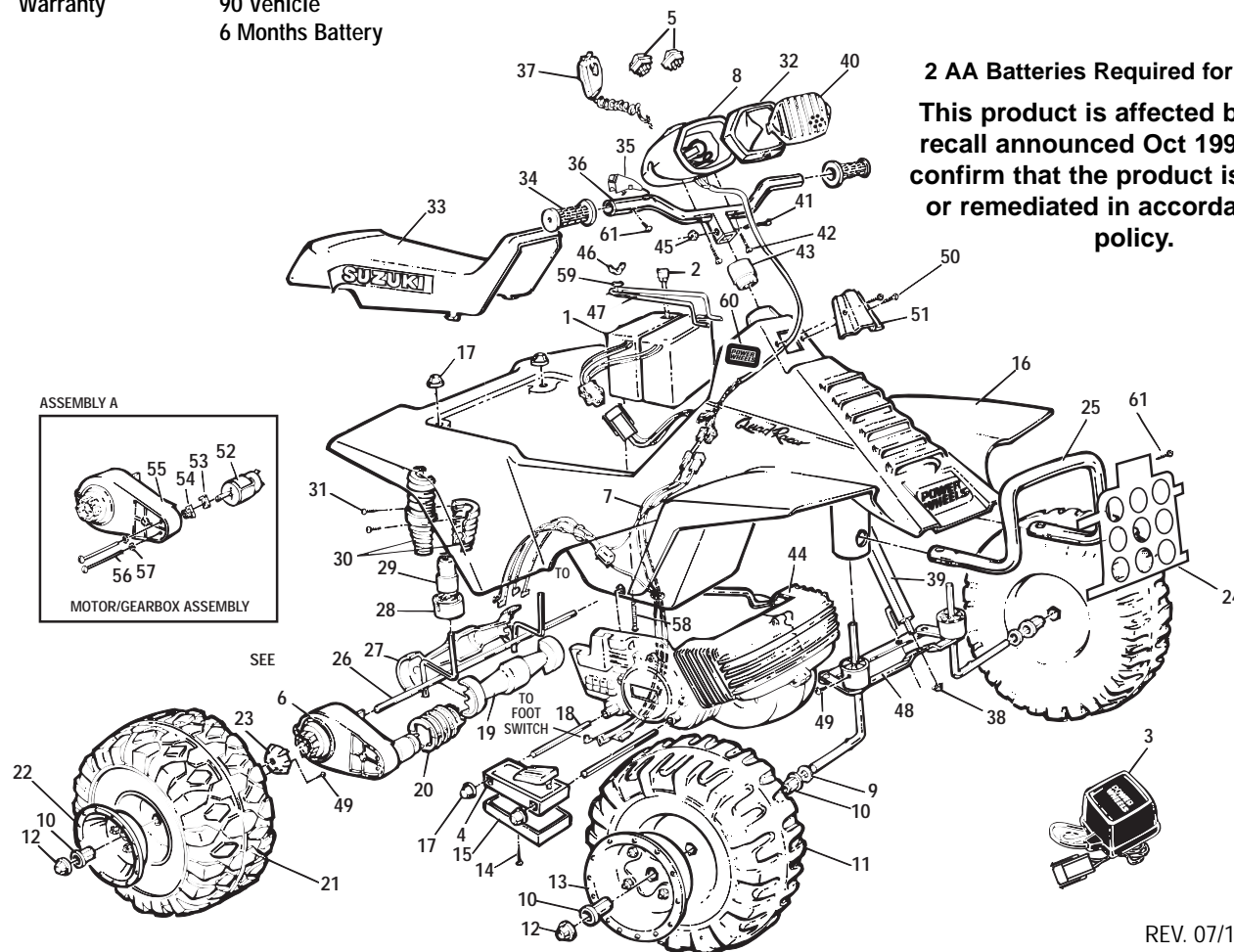

2 AA Batteries Required for Sound Box  
 This product is affected by the PW recall announced Oct 1998. Please confirm that the product is modified or remediated in accordance with policy.

REV. 07/10/03

| Item No. | Description                   | Part No.          | Qty.     | Item No. | Description                 | Part No.   | Qty. | Item No.                      | Description               | Part No.          | Qty.     |
|----------|-------------------------------|-------------------|----------|----------|-----------------------------|------------|------|-------------------------------|---------------------------|-------------------|----------|
| 1        | Battery, Type H               | 0801-0431         | 2        | 25       | Sport Bar (N/A)             | 80049-0064 | 1    | 49                            | #10 x 1/2" Phillips Screw | 0801-0255         | 4        |
| 2        | 30 Amp Fuse Kit               | 0801-0229         | 2        | 26       | Rear Axle                   | 76816-4539 | 1    | 50                            | #8 x 1/2" Phillips Screw  | 0801-0202         | 2        |
| 3        | Charger 12-Volt               | 0801-0225         | 1        | 27       | Axle Cover/Outside          | 80046-0093 | 1    | 51                            | Cover Plate (N/A)         | 80001-0199        | 1        |
| 4        | Footboard Assembly            | 76108-9159        | 1        | 28       | Rear Post Bushing (subbing) | 74570-2549 | 2    | 52                            | <b>Motor W/Pinion</b>     | <b>74590-9539</b> | <b>2</b> |
| 5        | Control Switch                | 0801-0148         | 2        | 29       | Rear Bushing w/Extension    | 76262-2549 | 2    | 53                            | D Lock Washer             | 0801-0329         | 2        |
| 6        | 3B Motor/Gearbox Assembly     | 78640-0640        | 2        | 30       | Shock Set (N/A)             | 80001-0198 | 2    | 54                            | Motor Drive Gear          | 74550-2269        | 2        |
| 7        | <b>Wiring Harness (Lower)</b> | <b>76262-9799</b> | <b>1</b> | 31       | 1/2" Screw                  | 0801-0222  | 4    | 55                            | <b>3B Gearbox Only</b>    | <b>74550-9279</b> | <b>2</b> |
| 8        | Headlight/Harness Assy.       | 80030-0086        | 1        | 32       | Headlight Rim               | 78680-2079 | 1    | 56                            | <b>Motor Bolts</b>        | <b>0801-0269</b>  | <b>4</b> |
| 9        | 7/16" Washer                  | 0801-0196         | 2        | 33       | Seat                        | 75560-2819 | 1    | 57                            | <b>Star Washer</b>        | <b>0801-0330</b>  | <b>4</b> |
| 10       | Hex Bushing                   | 73233-2559        | 6        | 34       | Handgrip                    | 76115-2179 | 2    | 58                            | Carriage Bolt             | 0801-0305         | 1        |
| 11       | Front Wheel                   | 76266-2459        | 2        | 35       | Sound Box Assembly          | 80001-0375 | 1    | 59                            | #10 Washer                | 76822-4409        | 1        |
| 12       | .437 Cap Nut                  | 0801-0214         | 4        | 36       | Handlebar                   | 80029-0034 | 1    | 60                            | Emblem                    | 74540-9069        | 2        |
| 13       | Front Hubcap                  | 73233-2579        | 2        | 37       | Microphone                  | 73233-9479 | 1    | 61                            | 3/4" Screw                | 0801-0223         | 7        |
| 14       | #8 x 2" Screw                 | 0801-0268         | 1        | 38       | Hat Cap                     | 76262-4429 | 1    | <b>PARTS NOT SHOWN</b>        |                           |                   |          |
| 15       | Bottom Cover/Footswitch       | 76108-2169        | 1        | 39       | Steering Column             | 80054-0020 | 1    | Footrest, Left                | 76108-2179                | 1                 |          |
| 16       | Body (N/A)                    | 76805-0248        | 1        | 40       | Headlight Lens              | 80030-0079 | 1    | Screws For Sound Box          | 0801-0222                 | 2                 |          |
| 17       | .354 Cap Nut                  | 0801-0215         | 6        | 41       | 1" Bolt                     | 76262-4459 | 1    | Use & Care Manual             | 78680-CCCC                | 1                 |          |
| 18       | Footboard Support Rod         | 76262-4439        | 2        | 42       | #6 x 1-1/2" Screw           | 0801-0221  | 2    | Decal Sheet                   | 76816-0310                | 1                 |          |
| 19       | Axle Cover/Inside (subbing)   | 74750-2739        | 1        | 43       | Steering Column Bushing     | 75560-2259 | 1    | (not original but comparable) |                           |                   |          |
| 20       | Motor Cover                   | 76803-2489        | 2        | 44       | False Motor (subbing)       | 74590-2069 | 1    |                               |                           |                   |          |
| 21       | Rear Wheel                    | 78570-2469        | 2        | 45       | Lock Nut                    | 0801-0318  | 1    |                               |                           |                   |          |
| 22       | Rear Hubcap                   | 74590-2579        | 2        | 46       | Wing Nut                    | 0801-0317  | 1    |                               |                           |                   |          |
| 23       | Driver                        | 73233-2239        | 2        | 47       | Battery Retainer            | 76262-4489 | 1    |                               |                           |                   |          |
| 24       | Brushguard                    | 78680-2259        | 1        | 48       | Steering Linkage (N/A)      | 80055-0057 | 1    |                               |                           |                   |          |

**Bold and Underlined parts are to be purchased and installed by Service Centers only. These items may not be sold directly to consumers by Service Centers or Fisher-Price.**

