

For 78490-9993 Wranglers produced *after* 3-22-98

Service Bulletin 161

Revised 78490-9993 Jeep® Wrangler

**Advanced Series
12-VOLT**

78490-993 Wrangler Phase 2
(New parts can not retro-fit original style)

- * Batteries moved from under seat to under hood
- * New front module
- * New dash (more leg room)
- * New windshield / frame assembly
- * New windshield brackets
- * New steering column (shorter)
- * New electrical assembly (footboard, wire harness & shifter)
- * New battery retainer (no screws necessary)
- * New seat (lock fastener changed to screw)
- * New manual
- * New main decal sheet (dash & front license plate updated)
- * Screw quantities changed
- * Motor covers removed / mtgrbox # change as a result
- * A screw in the shifter handle replaces the H.S. lockout pin.

Age Range: 3-7 Yrs.
Weight Limit: 130 Lbs.
Surfaces: Hard, Grass & Hills
Speed: 2.5 / 5.0 MPH Forward
 2.5 MPH Reverse
Colors: Red Body
 Black trim
Intro: 3-22-98
Suggested Retail: \$199.99
Box Dimensions: 50.25" x 19.6" x 33.4"
In Box Weight: 68 Lbs.
Warranty: 90 Days Vehicle
 6 Months Battery
 Rev. 01/12/04

This product is affected by the PW recall announced Oct 1998. Please confirm that the product is modified or remediated in accordance with policy.

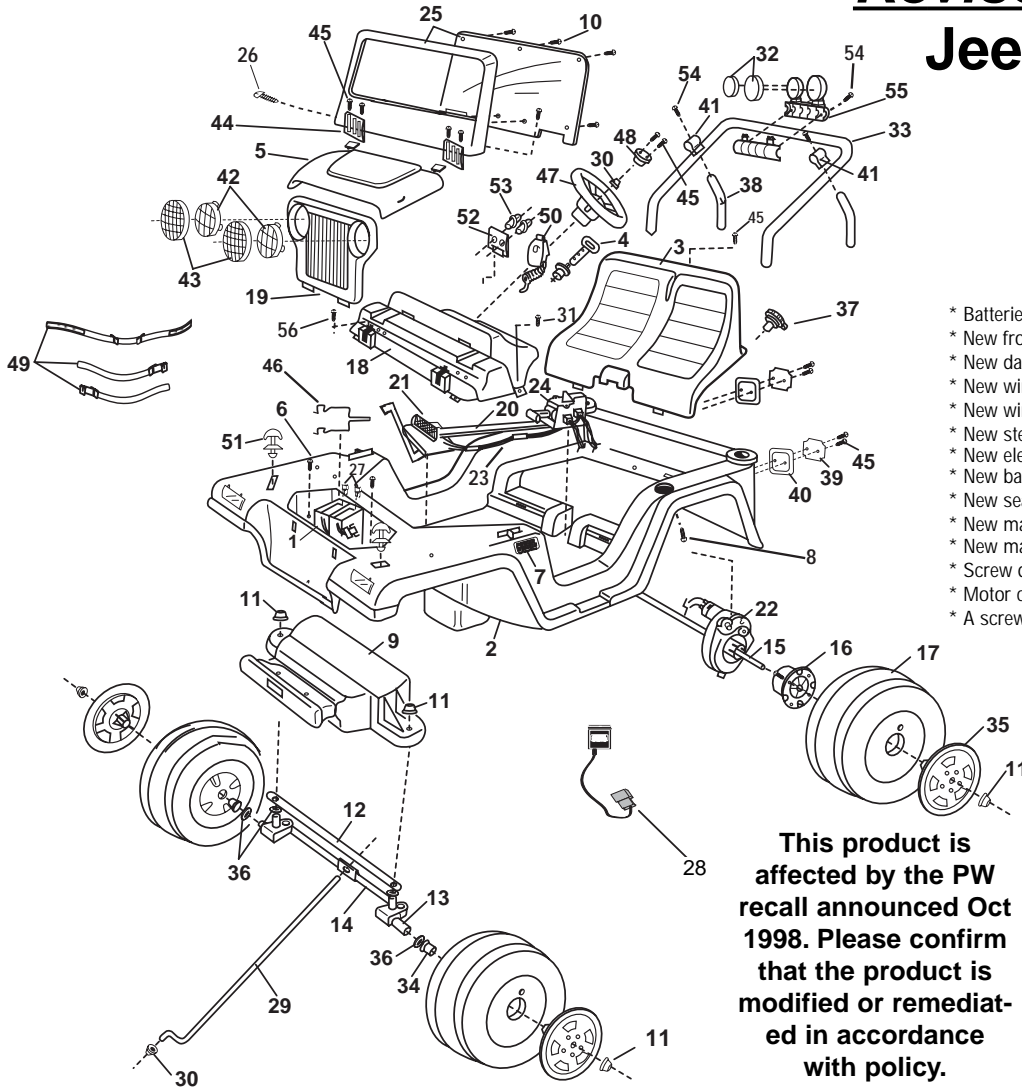

Item No.	Description	Part No.	Qty	Item No.	Description	Part No.	Qty.	Item No.	Description	Part No.	Qty.
1	*Battery	00801-0712	2	25	Windshield Assembly	78490-9769	1	49	Seatbelt Set	74460-5339	1
2	Body N/A	78490-2109	1	26	Frame Screw #10 x 3" N/A	0801-0256	2	50	Mic w/Cord	73233-9479	1
3	Seat	78490-2319	1	27	Thermal Fuse.	0801-0711	1	51	Hood Latch	78480-9559	2
4	Key/Housing Assembly N/A	74550-2439	1	28	*12 Volt Charger	00801-0973	1	52	Knob Bezel	74020-2719	1
5	Hood N/A	74440-2359	1	29	Steering Column	78490-4239	1	53	Dash Knob	74550-2719	2
6	1/4" x 1-1/2" Screw	0801-0578	2	30	.354 Cap Nut (Black)	0801-0604	3	54	#6 x 1-1/2" Screw	0801-0221	4
7	PW Emblem	74460-9069	2	31	#10 x 1/2" Screw N/A	0801-0540	2	55	Light Rack	78457-9349	1
8	1/4"x1-1/2" Roll Bar Scr N/A	0801-0467	2	32	Light Cover	74460-2169	2	56	#10 x 1" Screw (in dash)	0801-0220	2
9	Front Module N/A	78490-2119A	1	33	Sport Bar	74450-9219	1	Parts Not Shown			
10	Screw #8 x 1/2"	0801-0202	7	34	Axle Bushing	74550-2689	2		Decal Main Sheet N/A	78490-0320	1
11	.437 Cap Nut (Black)	0801-0226	6	35	Hubcap	74440-2579	4		*Literature Bag N/A	78490-9029	1
12	Cross Bar	74460-4419	1	36	7/16" Washer	0801-0196	4		*Large Parts Bag #1 N/A	78490-9349	1
13	Front Axle	74440-4509	2	37	Gas Cap	74526-2089	1		Large Parts Bag #2 N/A	78490-9389	1
14	Steering Linkage Assy.	74440-9419A	1	38	Sport Bar Support	78490-2229	2		*Small Parts Bag N/A	78490-9359	1
15	Rear Axle	74440-4519	1	39	Taillight Lens Set	73233-2279	1		Motor w/ Pinion	74440-9579	2
16	Wheel Driver	74460-2249	2	40	Taillight Housing Set	73233-2759	1		#7 Gearbox w/o Motor (Blk)	00968-2802	2
17	Wheel	3800-6799	4	41	Sport Bar Bracket Set	78490-2179	1		*Use & Care Manual	78490-0921	1
18	Dash N/A	78490-268A	1	42	Headlight Lens	74450-2279	2		1/4"x1-1/2" Roll Bar Screws (N/A)	0801-0467	2
19	Grille N/A	74440-2849	1	43	Headlight Lens Guard	74460-2339	2		(order small parts bag)	N/A	
20	Channel Cover N/A	74440-2289	1	44	Windshield Bracket N/A	78490-2779	2		Footswitch	00801-0933	
21	Footboard Assembly	78490-9829	1	45	#8 x 1" Screw N/A	0801-0224	11				
22	**#7 Gearbox w/Motor	00968-2902	2	46	*Battery Retainer	78490-4019	1				
23	*Harness Assembly	78490-9899	1	47	Steering Wheel	74440-2379	1				
24	Shifter Assembly	74310-9239	1	48	Steering Wheel Button	74550-2729	1				

N/A = Not Available

** number w/out motor cover is 78490-9619.

* See Service Bulletin 161

Bold and Underlined parts are to be purchased and installed by Service Centers only. These items may not be sold directly to consumers by Service Centers or Fisher-Price.

