



74440-9993 Jeep® Wrangler

Advanced Series
12-VOLT

Age Range: 3 - 7 Years
Weight Limit: 130 lbs.
Surfaces: Hard, Grass, Hills
Speed: 2.5 / 5 MPH
Colors: Red Body
Black Trim
Produced 4/96 - 12/12/97
Suggested Retail: \$199.99

Service Merchandise Version: 1-17-98 to 4-4-98
See Service Bulletin 155

Service Bulletin 146
Service Bulletin 148
Service Bulletin 155

This product is affected by the PW recall announced Oct 1998. Please confirm that the product is modified or remediated in accordance with policy.

Rev. 02/05/04

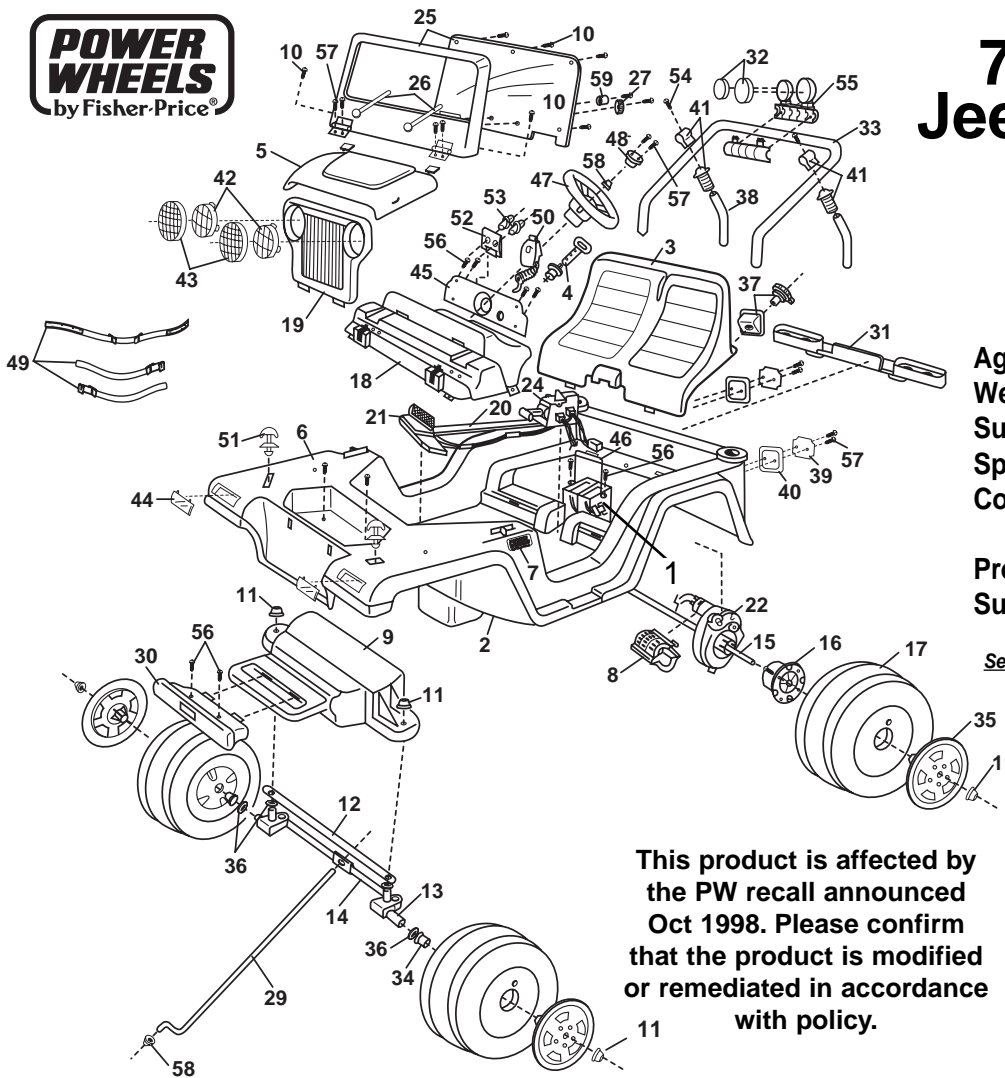

Item No.	Description	Part No.	Qty	Item Part	No. Item	Description	No. Part	Qty.			
1	Battery	00801-0712	2	28	Screw (Actuator) N/A	0801-0216	2	53	Dash Knob	74550-2719	2
2	Body N/A	74440-2109	1	29	Steering Column	78490-4239	1	54	*#6 x 1-1/2" Screw	0801-0221	4
3	*Seat N/A	74440-2319	1	30	Front Bumper N/A	73233-2519	1	55	*KCTM Light Rack	78457-9349	1
4	Key/Housing Assembly	74550-2439	1	31	Rear Bumper N/A	74440-2039	1	56	#8 x 3/4" Screw	0801-0223	8
5	Hood	75598-211A	1	32	*KCTM Light Cover	74460-2169	2	57	*#8 x 1" Screw	0801-0224	10
6	5/16" x 3-1/2" Hex Bolt N/A	0801-0192	2	33	*Sport Bar	74450-9219	1	58	.354 Cap Nut (Black)	0801-0604	3
7	PW Emblem	74460-9069	2	34	Axle Bushing	74550-2689	2	59	Cap N/A	73233-2619	1
8	Motor Cover	74750-2359	2	35	Hubcap	74440-2579	4	PARTS NOT SHOWN			
9	Front Module N/A	74440-2119	1	36	7/16" Washer	0801-0196	4		*Decal Main Sheet	74440-0370	1
10	Screw (Frame) #8 x 1/2"	0801-0202	5	37	Gas Cap/Flange Assem N/A	74440-9089	1		Literature Bag (N/A)		
11	.437 Cap Nut (Black)	0801-0226	6	38	Sport Bar Support	74440-4229	2		sub to owner's manl N/A	78490-0920	1
12	Cross Bar	74460-4419	1	39	Taillight Lens Set	73233-2279	1		#10 x 1" Screw (in dash)	0801-0220	4
13	Front Axle	74440-4509	2	40	Taillight Housing Set	73233-2759	1		Large Parts Bag #1 N/A	74440-9249	1
14	Axle Linkage Assy.	74440-9419A	1	41	**Sport Bar Bracket/Swivel Set		1		Large Parts Bag #2	74440-9279	1
15	Rear Axle	74440-4519	1		subs to 78490-2179 and 78490-2229		1		12v Charger	00801-0973	1
16	Wheel Driver	74460-2249	2	42	*Headlight Lens	74440-2879	2		**Small Parts Bag N/A	74440-9259A	1
17	Wheel	3800-6799	4		(changed from clear to blue 8-3-97)				Twist-Lock Fastener N/A	0801-0197	2
18	Dash N/A	74440-2689	1	43	*Headlight Lens Guard	74460-2339	2		Lock Fastener	78570-2439	1
19	Grille N/A	74440-2849	1	44	Turn Signal Lens	74440-2349	2		Motor W/ Pinion	74440-9579	2
20	Channel Cover N/A	74440-2289	1	45	*** Dash Plate N/A	74440-2679	1		#7 Gearbox w/o Motor (Blk)	00968-2802	2
21	Footboard Assembly	74440-9829	1	46	Battery Retainer	74440-4019	1		Fuse 30 Amp N/A	0801-0229	3
22	#7 Gearbox w/Motor	00968-2902	2	47	***Steering Wheel	74440-2379	1		Thermal Fuse	0801-0711	1
23	Harness Assembly	74440-9799	1	48	Steering Wheel Button	74550-2729	1		5/16" Hex Nyloc Nut N/A	0801-0193	2
24	see note below/Shifter Assy (Silver)	74440-9139	1	49	*Seatbelt Set	74460-5339	1		Use & Care Manual (N/A)	74440-0320B	1
25	Windshield Assembly N/A	74440-9769	1	50	Mid w/Cord	73233-9479	1		1/4"x1-1/2" Roll Bar Screws N/A	0801-0467	2
26	Wiper N/A	73248-2769	2	51	Hood Latch	74440-9559	2		Motor Bolts	0801-0269	2
27	Wiper Knobs N/A	73233-2449	1	52	Knob Bezel	74020-2719	1				

* See Service Bulletin 148
** See Service Bulletin 155
*** See Service Bulletin 146

Note: When ordering the shifter, please also send out (1) lock out screw 0801-0254 and (1) supplemental instructions 78490-0929.

Bold and Underlined parts are to be purchased and installed by Service Centers only. These items may not be sold directly to consumers by Service Centers or Fisher-Price.