

Age Range: 1-3 Yrs.  
 Weight Limit: 40 Lbs.  
 Surfaces: Hard, Grass & Carpet  
 Speed: 1 MPH Forward  
 Colors: White Body  
 Pink Wheels & Handgrips  
 Aqua Seat and Handlebars

Intro: 1993  
 Suggested Retail: \$76.99  
 Warranty: 90 Days Vehicle  
 6 Months Battery

# 73670-9993 / 83670 MERMAID BARBIE®

Toddler Series  
 Type H 6 Volt

## SERVICE BULLETIN 129

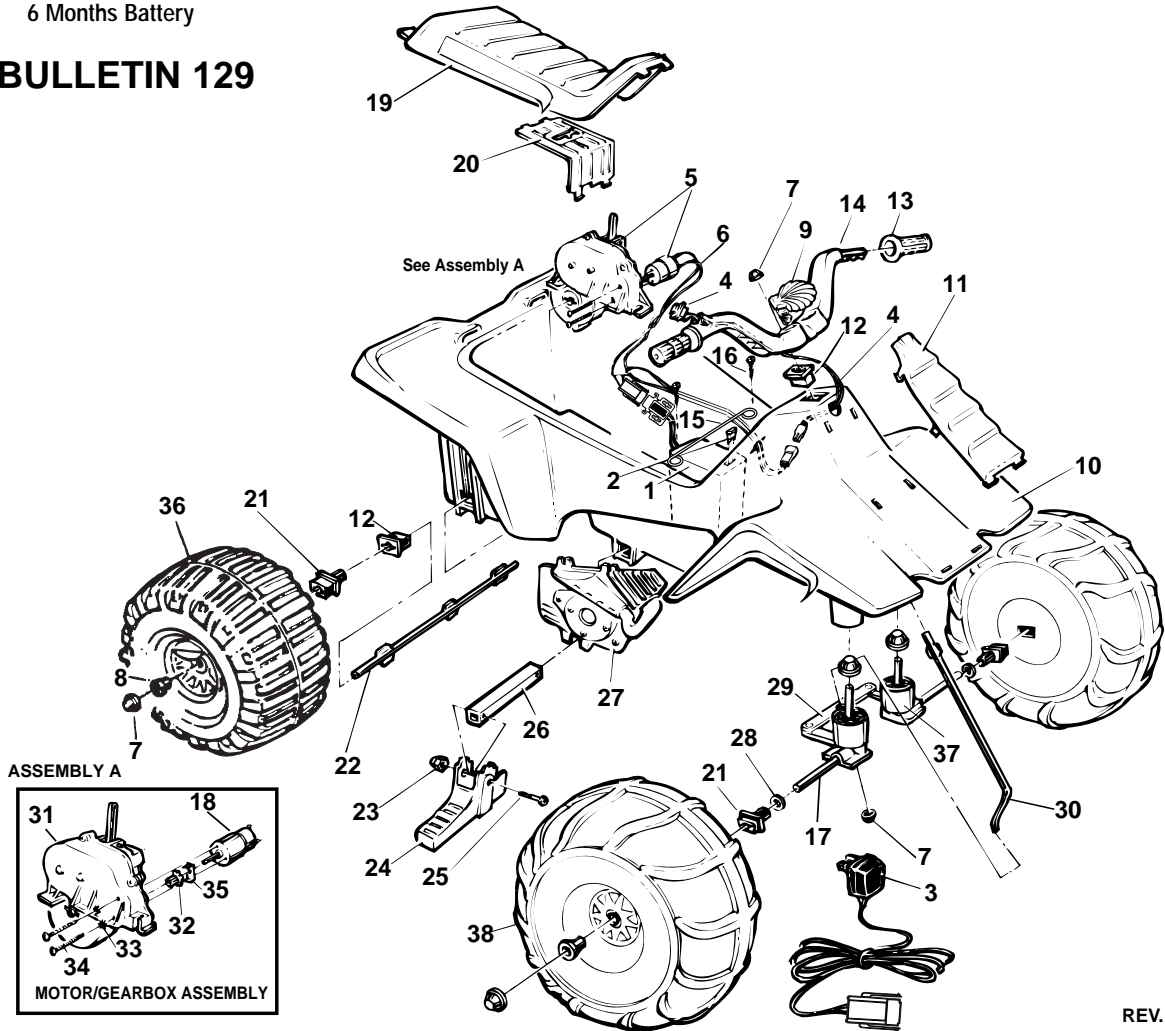

REV. 09/12/03

Item No.	Description	Part No.	Qty.	Item No.	Description	Part No.	Qty.	Item No.	Description	Part No.	Qty.
1	Battery 6 Volt (Type H)	00801-1234	1	16	#8 x 7/8" Trusshead Screw	0801-0228	2	33	<u>Star Washer N/A</u>	<u>0801-0330</u>	2
2	25 Amp Fuse	0801-0151	1	17	*Front Axle	74504-4509	2	34	<u>Motor Bolt</u>	<u>0801-0269</u>	2
3	Charger	00801-0975	1	18	<u>Motor 12 Volt N/A</u>	<u>73560-0640</u>	1	35	<u>D Lock Washer</u>	<u>0801-0329</u>	1
4	Switch Assembly	78560-9799	1	19	Seat N/A	80067-0016	1	36	Rear Wheel (subbing purple)	76980-2469	2
5	#5 Motor Gearbox Assy (Incl. #32,33,34 and 35)	74504-9519	1	20	Motor Cover	73560-9489	1	37	Front Post Bushing N/A	80009-0042	2
6	<u>Main Wiring Harness</u>	<u>73560-9799</u>	1	21	*Bushing w/Long Extension	78560-2659	4	38	Front Wheel N/A	73670-2469	1
7	.354 Cap nut (White)	0801-0548	8	22	Rear Axle	74504-4539	1	<b>PARTS NOT SHOWN</b>			
8	Wheel Bushing	78560-2679	4	23	Acorn Nut N/A	0801-0218	2	Tassels	73680-2129	2	
9	Microphone N/A	80038-0012	1	24	Footpeg N/A	80023-0040	2	Decal Sheet N/A	80017-0201	1	
10	Body (N/A)	77440-2109	1	25	1-1/4" Shoulder Bolt	0801-0304	2	Literature Bag N/A	80034-0466	1	
11	Grill N/A	80065-0021	1	26	Footpeg Support	76940-2179	1				
12	*Bushing w/o Extension	74504-2549	3	27	False Motor Set N/A	73670-2119	1				
13	Handgrips N/A	73670-2129	2	28	5/16" Washer	0801-0253	2				
14	Handlebar Switch			29	Steering Linkage	74504-4219	1				
15	Battery Retainer	74504-4429	1	30	*Steering Column	76940-4239	1				
				31	<u>#5 Gearbox</u>	<u>72629-9259</u>	1				
				32	<u>Motor Drive Gear NA</u>	<u>74504-2259</u>	1				

\* See service bulletin 129

N/A = Not Available

**Bold and Underlined parts are to be purchased and installed by Service Centers only. These items may not be sold directly to consumers by Service Centers or Fisher-Price.**